

# U.S. TSUBAKI POWER-LOCK®

MOST POPULAR STYLE

# AS Metric Series

## Hub Diameters for Single Unit Installation

$D_N$  is the minimum hub diameter required to tolerate  $P'$  or the pressure exerted from within the hub.

$$B \geq 2l$$

<EXAMPLE> Hub Material Yield Point = 35500 psi  
 PL030X055AS = 2.723" min. hub diameter

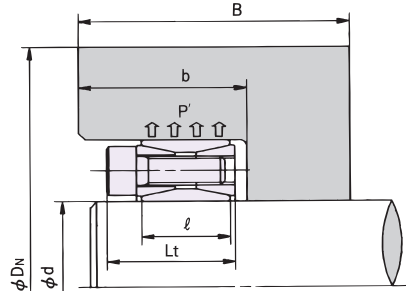

Hub Configuration Coefficient  $K_3=0.6$

## Min. Hub Dia. ( $D_N$ in inches)

Model Number	AS	Hub Contact Pressure $P'$ (psi)	Yield Point and Material examples									
			147 Mpa	176 Mpa	206 Mpa	225 Mpa	245 Mpa	274 Mpa	294 Mpa	343 Mpa	392 Mpa	441 Mpa
			21300 psi	25500 psi	29900 psi	32600 psi	35500 psi	39700 psi	42600 psi	49700 psi	56900 psi	64000 psi
				1010 304SS 316SS	1015 1118	1020	1030	1035 1040 1144	4140 1045	1055		
PL019X047	AS	12,328	2,657	2,494	2,383	2,330	2,286	2,234	2,205	2,149	2,109	2,078
PL020X047	AS	12,328	2,657	2,494	2,383	2,330	2,286	2,234	2,205	2,149	2,109	2,078
PL022X047	AS	12,328	2,657	2,494	2,383	2,330	2,286	2,234	2,205	2,149	2,109	2,078
PL024X050	AS	14,649	3,051	2,819	2,666	2,595	2,534	2,465	2,426	2,353	2,300	2,260
PL025X050	AS	14,649	3,051	2,819	2,666	2,595	2,534	2,465	2,426	2,353	2,300	2,260
PL028X055	AS	13,344	3,214	2,996	2,850	2,782	2,723	2,656	2,618	2,547	2,495	2,456
PL030X055	AS	13,344	3,214	2,996	2,850	2,782	2,723	2,656	2,618	2,547	2,495	2,456
PL032X060	AS	15,374	3,754	3,449	3,250	3,159	3,081	2,992	2,943	2,850	2,782	2,731
PL035X060	AS	15,374	3,754	3,449	3,250	3,159	3,081	2,992	2,943	2,850	2,782	2,731
PL038X065	AS	15,519	4,087	3,751	3,533	3,432	3,347	3,249	3,195	3,093	3,019	2,963
PL040X065	AS	15,519	4,087	3,751	3,533	3,432	3,347	3,249	3,195	3,093	3,019	2,963
PL042X075	AS	17,550	5,073	4,578	4,267	4,126	4,008	3,874	3,800	3,661	3,561	3,486
PL045X075	AS	17,550	5,073	4,578	4,267	4,126	4,008	3,874	3,800	3,661	3,561	3,486
PL048X080	AS	16,390	5,187	4,728	4,433	4,298	4,185	4,055	3,983	3,848	3,751	3,678
PL050X080	AS	16,390	5,187	4,728	4,433	4,298	4,185	4,055	3,983	3,848	3,751	3,678
PL055X085	AS	18,855	6,043	5,388	4,985	4,804	4,654	4,485	4,392	4,218	4,094	4,001
PL060X090	AS	17,840	6,154	5,540	5,155	4,981	4,835	4,670	4,579	4,409	4,287	4,195
PL065X095	AS	18,275	6,604	5,921	5,496	5,305	5,145	4,965	4,866	4,680	4,547	4,447
PL070X110	AS	19,290	7,956	7,062	6,517	6,275	6,072	5,845	5,721	5,489	5,324	5,200
PL075X115	AS	18,420	8,039	7,197	6,676	6,442	6,245	6,024	5,903	5,675	5,513	5,391
PL080X120	AS	17,840	8,205	7,386	6,873	6,641	6,447	6,227	6,106	5,879	5,716	5,594
PL085X125	AS	18,565	8,787	7,856	7,281	7,023	6,807	6,564	6,430	6,180	6,002	5,868
PL090X130	AS	17,840	8,889	8,002	7,446	7,195	6,984	6,746	6,615	6,368	6,192	6,060
PL095X135	AS	18,710	9,543	8,520	7,890	7,608	7,372	7,106	6,960	6,687	6,492	6,346
PL100X145	AS	18,420	10,136	9,075	8,417	8,122	7,875	7,596	7,443	7,156	6,951	6,797
PL110X155	AS	17,405	10,428	9,423	8,790	8,502	8,260	7,987	7,835	7,552	7,348	7,195
PL120X165	AS	17,840	11,282	10,156	9,451	9,132	8,865	8,562	8,396	8,083	7,860	7,692
PL130X180	AS	17,405	12,110	10,943	10,207	9,874	9,593	9,275	9,099	8,770	8,533	8,356
PL140X190	AS	17,550	12,851	11,599	10,810	10,453	10,153	9,813	9,626	9,274	9,022	8,832
PL150X200	AS	18,710	14,138	12,623	11,689	11,271	10,921	10,527	10,311	9,906	9,618	9,402
PL160X210	AS	18,710	14,845	13,254	12,273	11,834	11,467	11,053	10,826	10,402	10,099	9,872
PL170X225	AS	17,260	15,056	13,623	12,717	12,305	11,959	11,566	11,349	10,942	10,650	10,430
PL180X235	AS	17,550	15,895	14,346	13,370	12,929	12,558	12,137	11,905	11,470	11,159	10,924
PL190X250	AS	16,245	16,126	14,715	13,809	13,393	13,042	12,643	12,421	12,003	11,703	11,476
PL200X260	AS	16,390	16,858	15,365	14,408	13,970	13,600	13,179	12,946	12,506	12,190	11,952
PL220X285	AS	16,680	18,672	16,979	15,897	15,404	14,987	14,514	14,252	13,759	13,405	13,138
PL240X305	AS	17,405	20,519	18,543	17,296	16,730	16,254	15,716	15,418	14,860	14,459	14,158
PL260X325	AS	18,710	22,975	20,512	18,995	18,315	17,746	17,106	16,755	16,098	15,629	15,278
PL280X355	AS	16,535	23,137	21,064	19,737	19,131	18,619	18,036	17,714	17,107	16,671	16,342
PL300X375	AS	17,115	24,960	22,613	21,125	20,448	19,878	19,232	18,875	18,203	17,722	17,359

D - PT COMPONENTS